



0.005 Lux Color

2Megapixel Camera
60mm/F0.8 Mono-focal DC Lens

Super Bright Surveillance Camera & Lens

Crystal
Clear
Optics

Coming Soon



NEW

LM60JS5MA

1" 60mm/F0.8 5MP



NEW

SC200PK1C

2/3" CMOS 2MP Color 0.005 Lux

Designed for high end surveillance applications where high resolution color images are required, even in very low light areas. Our 60mm/F0.8 5MP lens is 6 times brighter than any standard 50mm/F2.0 lens in the market.

The SC200PK1C provides an 30fps color image even at 0.005 Lux, the excellent sensitivity of this camera is comparable to the EMCCD, the currently the highest sensitive CCD type camera in the market place. Therefore the combination of our 60mm/F0.8 5MP lens and the SC200PK1C provides the brightest color image in low light condition in the world today.



The brightest
color image



Super Bright Surveillance Camera & Lens

LM60JS5MA

1" 60mm/F0.8 5MP

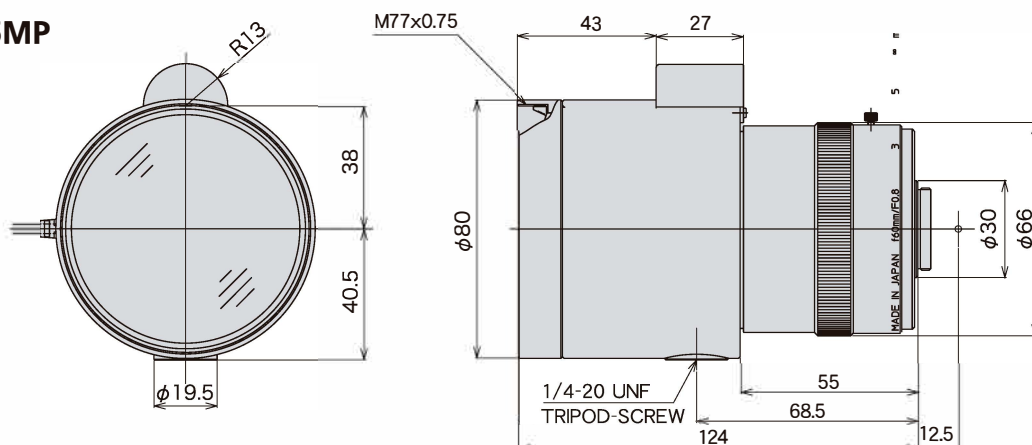

SC200PK1C

2/3" CMOS 2MP Color 0.005 Lux

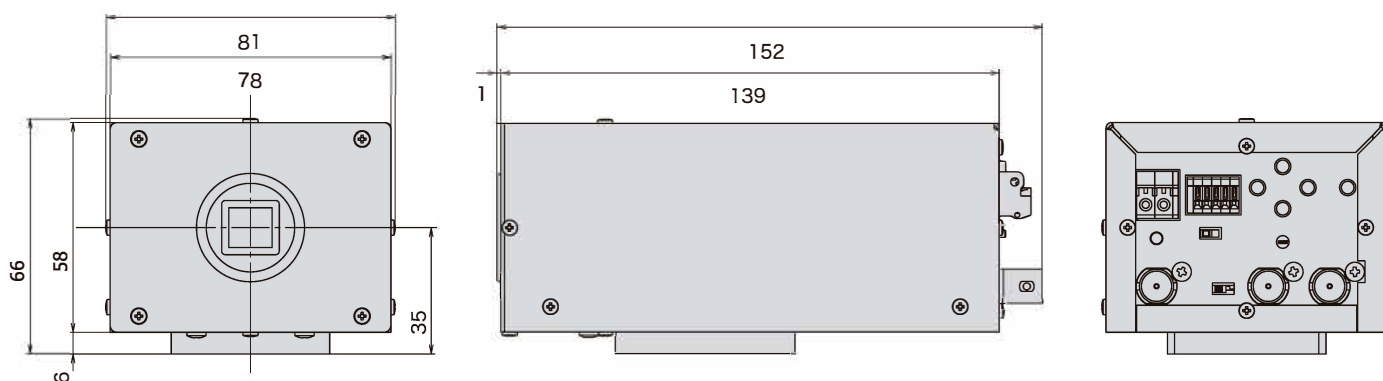

SPECIFICATION LM60JS5MA (Preliminary)

| | |
|----------------------------|------------|
| 1. Format | 1" |
| 2. Focal Length | 60mm |
| 3. F-Stop | F0.8 |
| 4. Image Size | φ 16mm |
| 5. Angle of View | DIA. 16.0° |
| | HOR. 12.8° |
| | VER. 9.6° |
| 6. Distortion | -0.30% |
| 7. Minimum Object Distance | 2m |
| 8. Back Focus | 20mm |
| 9. Filter Size | M77x0.75 |
| 10. Front Lens Dia. | φ 70mm |
| 11. Mount | CS – MOUNT |
| 12. Resolution | 5MP |
| 13. Weight | 1,100g |

*Specifications are subject to change without notice.

SPECIFICATION SC200PK1C (Preliminary)

| | |
|----------------------|---------------------------|
| Imaging Device | 2/3" CMOS |
| Valid Pixels | Approx 2M pixels |
| Pixel Size | 5.0μm |
| Scanning Method | Progressive |
| Minimum Illumination | 0.005Lux (F1.4) 30fps |
| S/N | More than 50dB |
| Synchronization | Internal/External |
| Gain | 0~72dB |
| Shutter Type | Rolling Shutter |
| Lens Mount | CS |
| Iris Control | DC |
| Day & Night | IR Cut Filter ON/OFF |
| Video Output | HD:HD-SDI / SD:NTSC, PAL |
| Output Format | 1920 x 1080 / 30 29.97 25 |
| Remote Control | RS-485 |
| Input Voltage | DC12V |
| Power Consumption | Lower than 10W |
| Dimension | 78(W)x58(H)x140(D) |
| Weight | 650g |